

## M3-310

### Media Player Board with LCD Connection

#### Key Features :

- > Direct LCD drive
- > Easily integrated
- > Compact Flash Storage
- > Content Programmable using DV Studio

The M3-310 is a board-level solid-state digital video/audio player integrated with a LCD interface for driving a LCD panel directly. Videos and pictures are stored and played directly from a Compact Flash memory card.

#### Content Format supported

Supported Resolution :	MPEG - 1 (.mpg) 352 x 288, PAL, 25fps MPEG - 1 (.mpg) 352 x 240, NTSC, 29.97fps MPEG - 2 (.mpg) 720 x 576, PAL, 25fps MPEG - 2 (.mpg) 720 x 480, NTSC, 29.97fps MPEG - 4 DivX (.avi) 720 x 576, PAL, 25fps MPEG - 4 DivX (.avi) 720 x 480, NTSC, 29.97fps
Still Picture :	JPEG (.jpg)
Audio :	44.1kHz Stereo, 224kbit/s

#### Features

Panel Signal :	TTL(single pixel) and LVDS
OSD Functions :	Set Date/Time/ID / Volume / Brightness/Contrast
IR Control :	Display/0-9/Play/Stop/Repeat/ Pause/Volume/Track/Mute
Play Modes :	Playlist mode / Simple play mode Schedule playback
USB Update :	Entire/Partial update Auto power cycling after USB plug/unplug
Interactivity :	Supports up to 16 buttons Touch screen (ITO & Analog) Motion sensor Barcode code scanner Serial port control

#### Options

CF Card, DV IR handset, Speakers, Volume knob, Touch glass, 8-button keypad, Power supply, Cables, DV Studio software, OSD switchmount kit, Panel cable

#### Specifications

Panel Connectivity :	1600x1200 1280x768 800x480	1366x768 1024x768 640x480
Storage Media :	Compact Flash Card Type 1/2	
Audio output :	Speaker out	
Playback functions :	Play / Stop / Pause / Repeat / Previous track / Next track / Volume / Mute Loop playback / Sequence play / Startup mode / Sleep mode	
External I/O ports :	RS-232 (9600, N-8-1) USB (Content upload) Infra-red (Use with DV IR handset) Remote Ext. (For button & touch)	
LEDs :	Power LED (Green) Status LED (Green)	
Watchdog :	Support system reset	
Real time clock :	Battery-backup RTC	
Power requirement :	DC 12V input	
Aux. power out : (with fuse protect)	5V DC and 12V DC	
Power consumption :	560mA@12V (no panel connection)	
Operating Temperature :	0°C to 50°C	
Relative humidity :	5% - 95% relative humidity (Non-condensing condition)	
Dimension (WxDxH):	147 x 92 x 18mm	
Weight (net) :	135g	

# M3-310

Media Player Board with LCD connection

## Mechanical Drawing

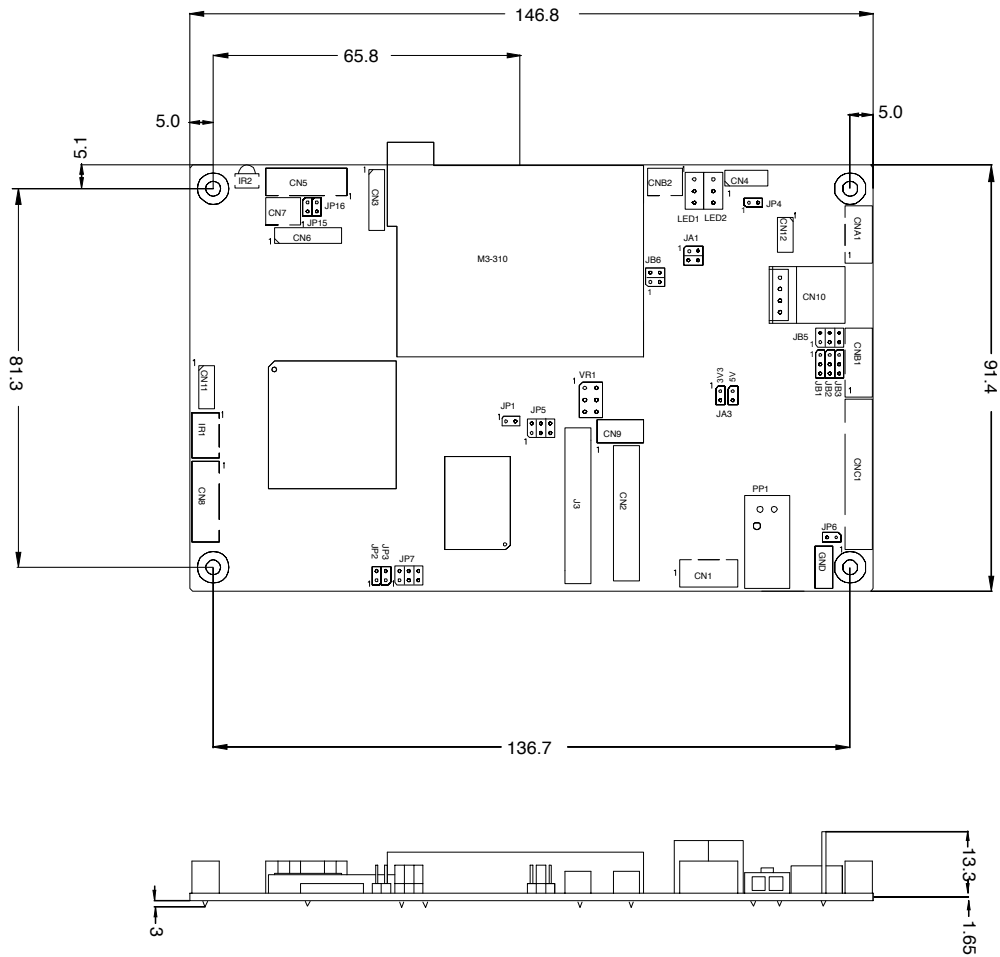

## Ordering Options

P/N 417200021-3	M3-310
P/N 426451401-3	Remote Ex. cable
P/N 416101300-3	8-button switchmount for Remote Ex.
P/N 559000106-3	IR remote handset
P/N 426090400-3	RS-232 Ext. Cable

### EUROPE

The Lake House, Knebworth Park, Herts, SG3 6PY, UK  
t : +44 (0) 20-7631-2150

### ASIA

16th Floor Millennium City 3, 370 Kwun Tong Road, Kwun Tong, Hong Kong  
t : (852) 2861-3615

### USA

18440 Technology Drive, Morgan Hill, CA 95037, USA  
t : +1 (408) 782-7773