

Application Note

System connection for HD-3000 with SGX-1920L

Application Note: System Connection for HD-3000 & SGX-1920L



Version: 1.02

Date: 14-February-2012

Revision History

Date	Rev No.	Page	Summary
07 Oct 2011	1.00	All	First issued
24 Nov 2011	1.01	All	Document format changed.
14 Feb 2012	1.02	All	Document format changed and add contact page.

Application Note: System Connection for HD-3000 & SGX-1920L



Version: 1.02

Date: 14-February-2012

System connection for HD-3000/HD-3000S with SGX-1920L:

For 12VDC power input connection:

Use HDMI extend cable P/N 426302600-3 connect between HDMI1A /HDMI2A on HD-3000 and J1 on SGX-1920L.

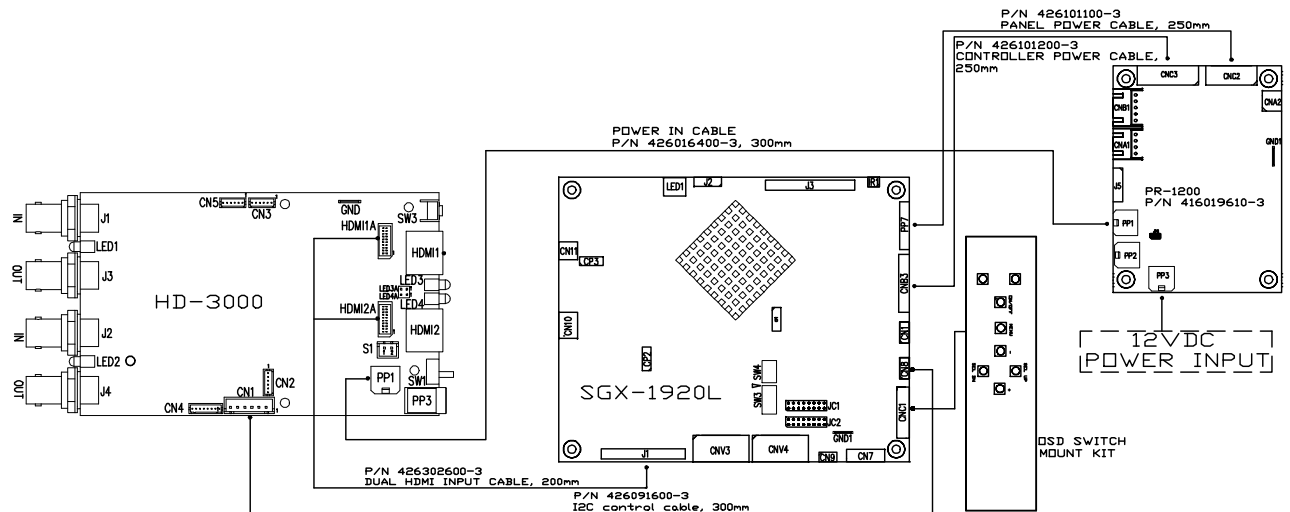

KIT 70706-3 includes the following items :

Item	Part number	Description	Quantity
1	4160160XX-3	HD-3000	1
2	426302600-3	Dual HDMI Input Cable, 200mm	1
3	426016400-3	Power In Cable, 300mm	1
4	426091600-3	I ² C Control Cable, 300mm	1
5	416019610-3	PR-1200	1
6	426101100-3	Panel Power Cable, 250mm	1
7	426101200-3	Controller Power Cable, 250mm	1
3	426016900-3	Power In Cable, 400mm	1
4	426091100-3	I ² C Control Cable, 300mm	1

Application Note: System Connection for HD-3000 & SGX-1920L

Version: 1.02

Date: 14-February-2012

For 24VDC power input connection :

Use HDMI extend cable P/N 426302600-3 connect between HDMI1A /HDMI2A on HD-3000 and J1 on SGX-1920L.

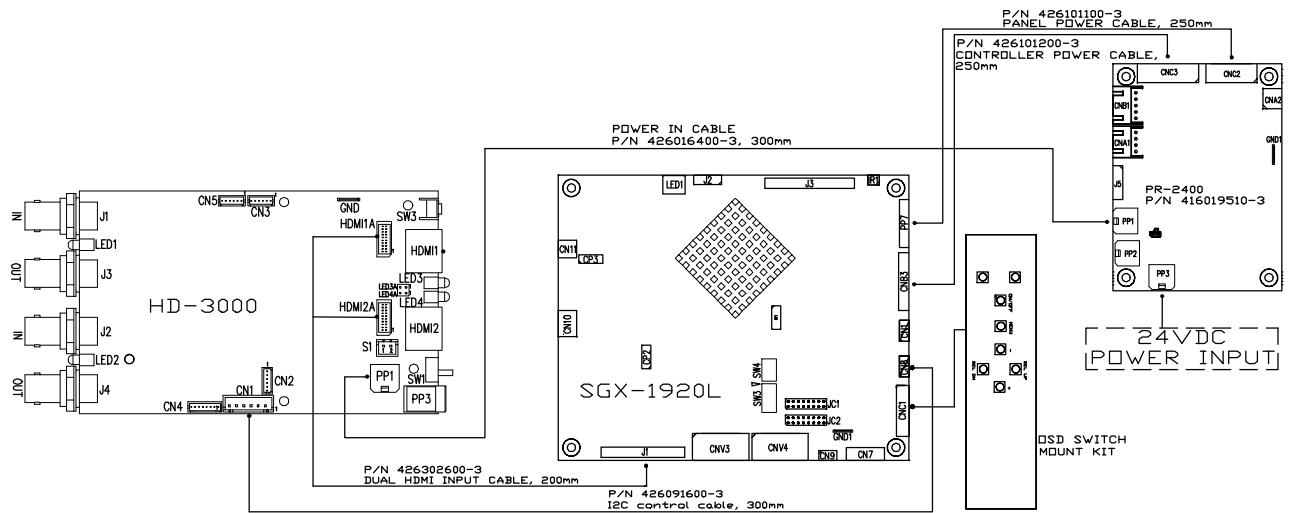

KIT 70707-3 includes the following items :

Item	Part number	Description	Quantity
1	4160160XX-3	HD-3000	1
2	426302600-3	Dual HDMI Input Cable, 200mm	1
3	426016400-3	Power In Cable, 300mm	1
4	426091600-3	I ² C Control Cable, 300mm	1
5	416019510-3	PR-2400	1
6	426101100-3	Panel Power Cable, 250mm	1
7	426101200-3	Controller Power Cable, 250mm	1

Application Note: System Connection for HD-3000 & SGX-1920L



Version: 1.02

Date: 14-February-2012

CONTACT DETAILS

USA: Digital View Inc.
18440 Technology Drive
Building 130
Morgan Hill, CA 95037
Tel: (1) 408-782 7773 **Fax:** (1) 408-782 7883
Sales: ussales@digitalview.com

EUROPE: Digital View Ltd.
The Lake House
Knebworth Park
Herts, SG3 6PY
UK
Tel: (44) (0)20 7631 2150 Fax : (44) (0)20 7631 2156
Sales : uksales@digitalview.com

ASIA: Digital View Ltd.
16th floor Millennium City 3
370 Kwun Tong Road
Kwun Tong
Hong Kong
Tel: (852) 28613615 Fax: (852) 25202987
Sales: hksales@digitalview.com

The content subject to change without notice

Application Note – System connection for HD-3000 with SGX-1920L

(February 2012)

© Digital View Ltd 2012
