

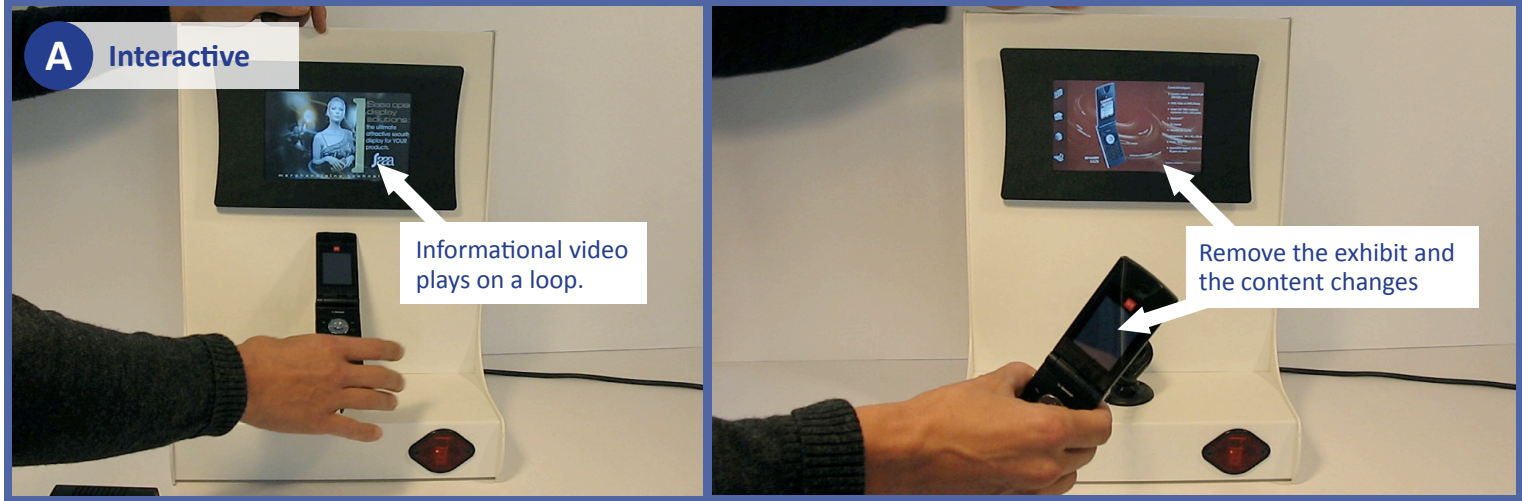

# Interactive Anti-Theft Cradle

## Museum Exhibits / POP Displays



**A Interactive**

Informational video plays on a loop.

Remove the exhibit and the content changes



**B Anti-Theft**

... or remove the device.

Cut the wire...

& the  
**ALARM  
SOUNDS**

Switch off the alarm with the remote

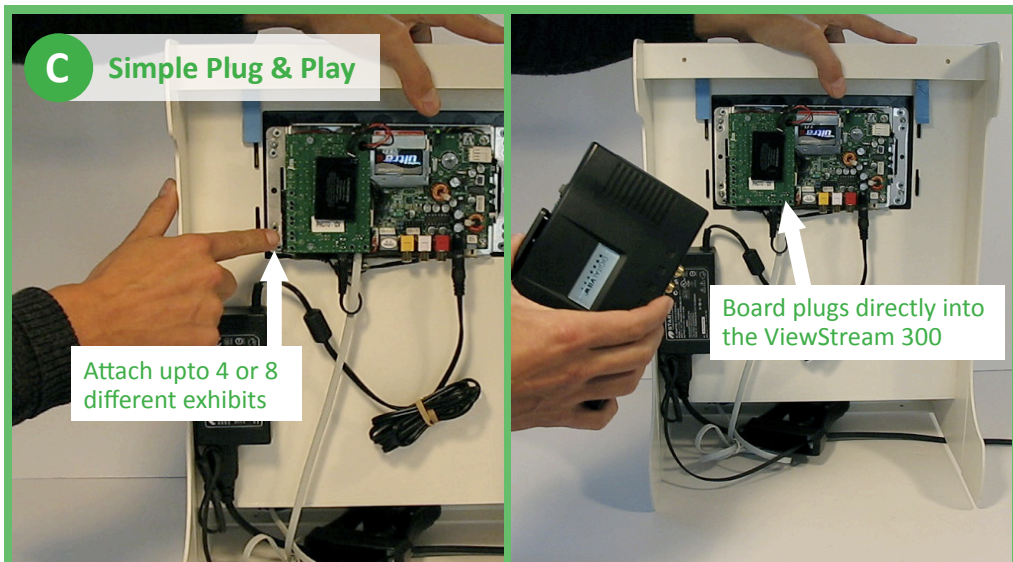

**C Simple Plug & Play**

Attach upto 4 or 8 different exhibits

Board plugs directly into the ViewStream 300

### Ingredients.

- 1 x 7" LCD Screen
- 1 x Universal Product Cradle
- 1 x ViewStream Media Player
- 1 x Anti-Theft Add-On Board
- 1 x CF Card with Content
- 1 x Alarm Remote
- 1 x Power Supply

### Accessorize Your ViewStream Players



watch the full video at:

[youtube.com/digitalviewgroup](http://youtube.com/digitalviewgroup)