



## M3-310 RoHS

The M3-310 is a board-level solid-state digital video/audio player integrated with a LCD interface for driving a LCD panel directly. Videos and pictures are stored and played directly from a Compact Flash memory card.

### CONTENT FORMAT SUPPORTED

Video:	- MPEG - 1 (352 x 288, PAL, 25fps) - MPEG - 1 (352 x 240, NTSC, 29.97fps) - MPEG - 2 (720 x 576, PAL, 25fps) - MPEG - 2 (720 x 480, NTSC, 29.97fps) - MPEG - 4 (720 x 576, PAL, 25fps) - MPEG - 4 (720 x 480, NTSC, 29.97fps)
Still Picture:	- JPEG
Audio:	- 44.1kHz Stereo, 224kbit/s
Codec	- MPEG-1/2 (.mpg), JPEG (.jpg) - MPEG-4 DivX (.avi)

### FEATURES

Panel Connectivity:	1600 x 1200 1280 x 768 1024 x 768 800 x 600	1280 x 1024 1366 x 768 640 x 480 800 x 480
Panel Power:	Supports 3.3v / 5v panels	
Panel Signal:	TTL(single pixel) and LVDS	
OSD Functions	Set Date/Time/ID Volume Brightness/Contrast	
IR Control:	Display / 0-9 / Play / Stop / Repeat / Pause / Volume / Track / Mute	
Play Mode:	Playlist mode Simple play mode Schedule playback	
USB Update:	Entire/Partial update Auto power cycling after USB plug / unplug	
Interactivity:	Supports 16 buttons Touch screen Motion sensor Barcode code scanner Serial port control	

### SPECIFICATION

Playable format :	.mpg / .jpg / .avi
Storage media :	Compact Flash Card
Audio output :	Speaker Out
Playback Functions:	Play / Stop / Pause / Repeat / Previous track / Next track / Volume / Mute Loop playback / Sequence play / Startup mode / Sleep mode
Touch screen functions:	Support Analog touch glass and ITO (segment type) touch glass
External I/O ports:	RS-232 (9600, N-8-1) USB (Content upload) Infra-red (Use with DV IR handset) Remote Ext. (For button & touch)
LEDs :	Power LED (Green) Status LED (Green)
Watchdog:	Support system reset
Real time clock :	Battery-backup RTC
Aux. power out : (with fuse protect)	5V DC and 12V DC
Power requirement :	DC 12V input
Power consumption :	560mA@12V (no panel connection)
Operating Temperature :	0 C to 50 C
Relative humidity :	5% - 95% relative humidity (Non-condensing condition)
Dimension : (WxDxH)	147 mm x 92 mm x 18mm
Weight (net) :	135g

### OPTIONS

CF Card, DV IR handset, Speakers, Volume knob, Touch glass, 8-button keypad, Power supply, Cables, DV Studio software, OSD switchmount kit, Panel cable

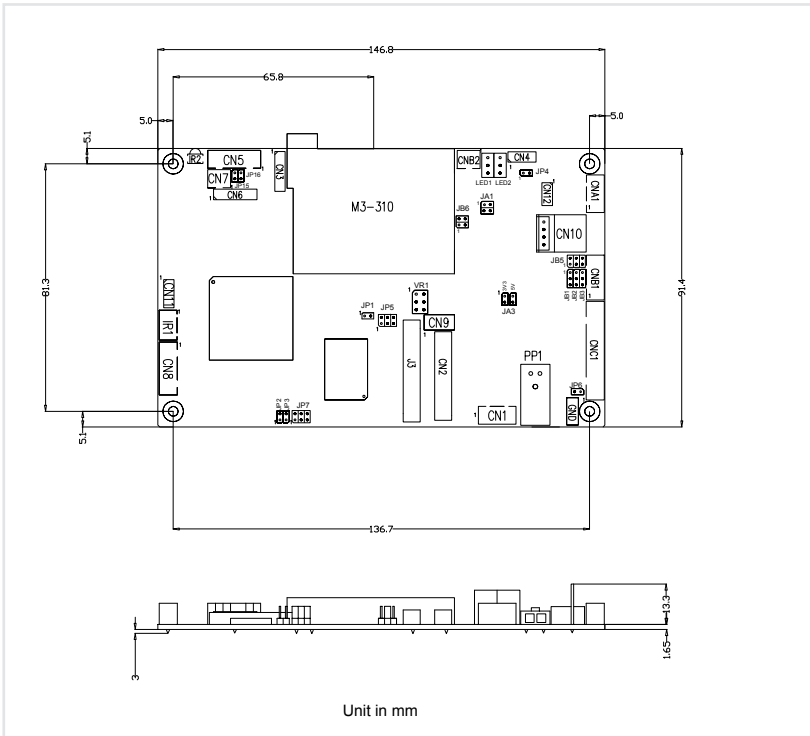

## CONNECTOR DEFINITIONS

CN1	Speaker out (L/R)
CN2	TTL panel connector
CN3	Switches and buttons (#9-#16)
CN5	RS-232 port
CN6	Switches and buttons (#1-#8)
CN7	Resolution switch (480p/720p)
CN8	Serial port for panel control
CN9	Alternative line out
CN10	Alternative power out
CN11	Reserved
CN12	USB connector
CNA1	Auxiliary power output
CNB1	Backlight inverter
CNB2	Inverter status
CNC1	OSD control
PP1	Power input
IR1	IR connector
VR1	Volume control connector
J3	LVDS panel connector
LED1	Controller status
LED2	Backlight status

## ACCESSORIES

4460104-01-3	IR sensor kit
5590001-04-3	IR handset
4268905-00-3	Volume control knob
4264514-01-3	Remote Ex. cable
4161013-00-3	8-button switchmount for Remote Ex.

## AVAILABLE DOCUMENTATION

- [M3-310 User Guide](#)
- [Content Creation Guide](#)
- [Firmware Upgrade Procedure](#)
- [DV Studio Plus User Guide](#)
- [Application Notes](#)

## CUSTOM ENGINEERING SERVICES

Digital View offers a wide range of customization for OEM customers. Services range from unique part number and configuration control, through custom layouts and features.

Digital View offers managed product lifecycles with extended product lifetime options and EOL planning. US manufacturing is available on all Digital View products.

### USA

Digital View Inc.

18440 Technology Drive  
Morgan Hill, CA 95037,  
USA

Tel : +1 (408) 782-7773

### EUROPE

Digital View Limited

6 Marylebone Passage  
London, W1W 8EX  
UK

Tel : +44 (0) 20-7631-2150

### ASIA

Digital View Ltd.

16th Floor Millennium City 3  
370 Kwun Tong Road  
Kwun Tong, Hong Kong

Tel : (852) 2861-3615